



1/51 Gourlay Street ST KILDA EAST

2 1 1

A renovated 2 bedder you can afford

\$ 508,000

Fully refurbished and flawlessly presented with easy-care interiors, this light filled ground floor Strata apartment makes for a fantastic first home or investment option enhanced by its brilliant location between Ripponlea Village and Carlisle Street.

Joey Eckstein
0419419199
jeckstein@wilsonagents.com.au

Generously spaced open-plan living and dining areas, modern kitchen featuring gas appliances and ample storage. Both spacious bedrooms feature built-in robes and leafy outlooks, stylish bathroom with laundry provisions, heating, allocated off-street parking, intercom entry and all this in a boutique block of just 6.

Peter Fein
0418528888
peter@wilsonagents.com.au

Around the corner to leafy Greenmeadows Gardens, close to multiple tram routes and train stations, and just a stroll to the vibrant shops, cafés and amenities of Ripponlea Village and Carlisle Street.

1/51 Gourlay Street, St Kilda East

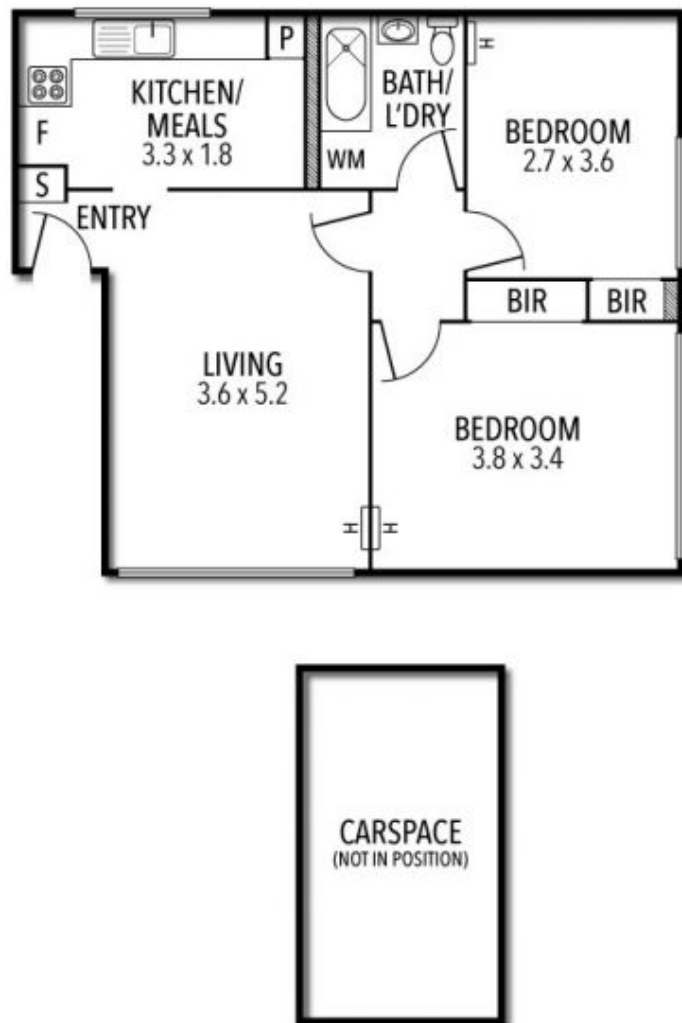

This plan has been prepared for marketing purposes only. Please note that all measurements & angles are approximate only, so it is strongly advised that all interested parties should undertake their own investigation into the accuracy of the supplied information.
No representations or warranties of any nature whatsoever are given or attended.