



5 Balaclava Road ST KILDA EAST

4 2 4

Expansive Home with Unbeatable Convenience

Nestled in the vibrant heart of St Kilda East, this delightful and serene two-story family home perfectly combines comfort, space and sophistication. With its bright and peaceful ambiance, it boasts both formal and informal living areas, providing spacious accommodation that enhances its desirability in this prime location.

Upon entering, you are welcomed by a grand entrance hall showcasing polished timber floors and a lovely green outlook. This expansive downstairs domain leads into a large, light-filled family room that effortlessly connects to an elegantly spacious formal lounge and an adjoining dining room, complete with custom-built cabinetry that enhances the home's charm and functionality.

The well-appointed granite kitchen is equipped with modern appliances including an induction cooktop and dishwasher and an abundance of storage space. It overlooks a family meals area, creating a perfect setting for casual dining. From here, step out onto an elevated and large alfresco patio that invites you to enjoy outdoor gatherings while

\$1,960,000 - \$2,150,000

Joey Eckstein
0419419199
jeckstein@wilsonagents.com.au

Peter Fein
0418528888
peter@wilsonagents.com.au

5 Balaclava Road, St Kilda East

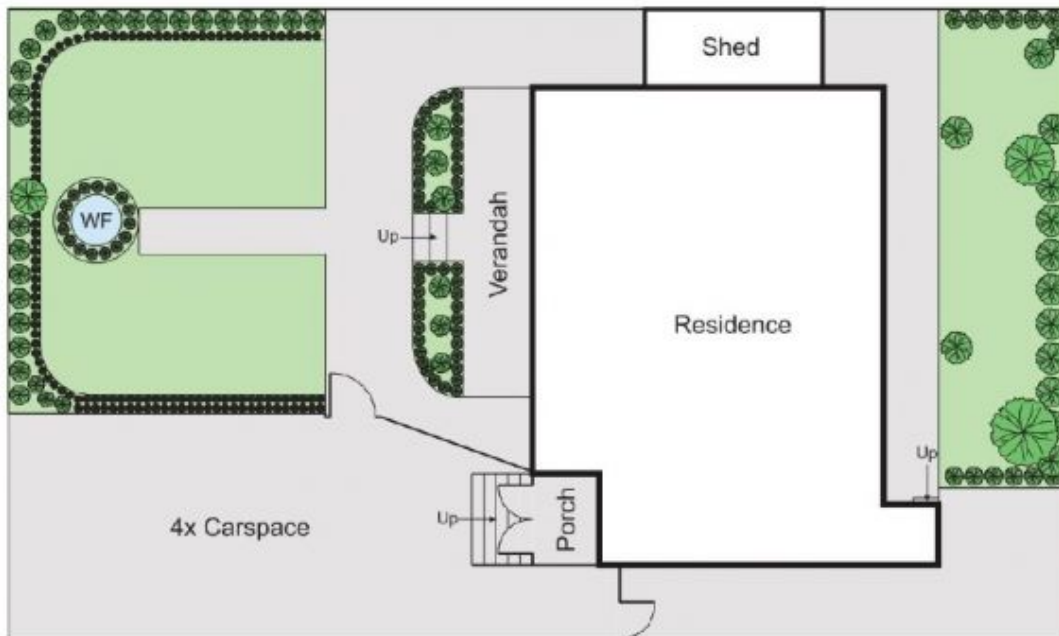
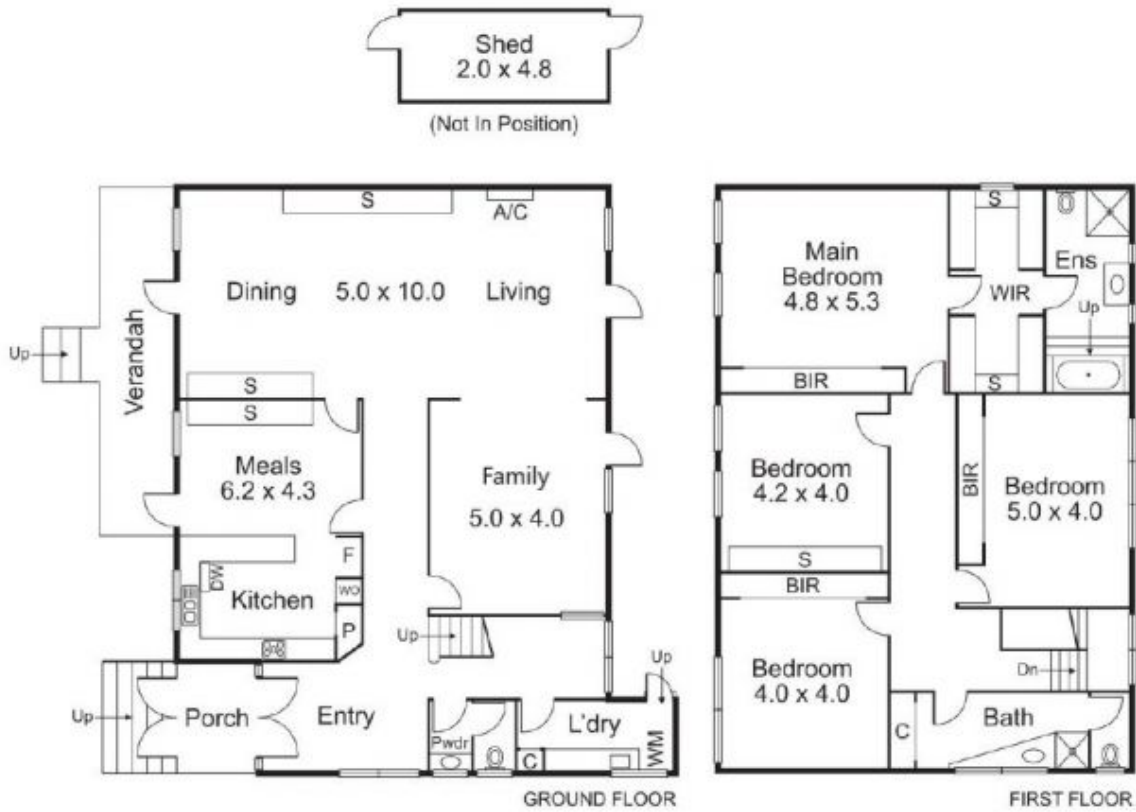

This plan has been prepared for marketing purposes only. Please note that all measurements and angles are approximately only, so it is strongly advised that all interested parties should undertake their own investigation into the accuracy of the supplied information.
No representation or warranties of any nature whatsoever given or attended.